



Place des Arts
Québec

SALLE CLAUDE-LÉVEILLÉE

UPDATED - July 2021

Covid-19 Important note concerning the information's registered in this technical rider.

During the pandemic and until further notice; the capacities of all backstage rooms and spaces have been lowered to favor physical distancing and are posted on doors end entrances of each of these spaces.

The technical documentation of the venue that include stage, sound or lighting is not list as a contract. Contact the technical department for an update on this document.

Informations Générales / General Informations

House

Elizabethan theater featuring fixed or detachable panels. Seating on three sides.

	Normal	Reduced
Seating		
seating capacity for booking	128	71
house seats	6	-
booking capacity	122	71
House dimensions		
from house curtain to last row	3,96 m	13'-0"
from center line to S.R. wall	7,31 m	24'-0"
from center line to S. L. wall	7,77 m	25'-6"

Artists entrance

central security office

Quai de chargement - Loading dock

145 Ste.Catherine Street West (emergency exit)
(single glass door)

1444 St.Urbain Street
loading dock

Production office

backstage in the dressing room area
telephone :

Tt 04078
514-285-4381

Dressing rooms

dressing rooms sharing toilet and shower
main dressing room (4 mirrors and a sink) 1 person
dressing room (3 mirrors and a sink) 1 person

2
Tt 04076
Tt 04077

Salles de répétitions - Rehearsal rooms

available upon request



SALLE CLAUDE-LÉVEILLÉE

Stage

Stage description and dimensions

oak floor.		
stage height	0,33 m	13"
total width	5,49 m	18'-0"
total depth	3,96 m	13'-0"
maximum height	2,36 m	7'-9"
fixed column on stage	66 cm x 66 cm	26" x 26"
front of column to front of stage	2,74m	9'-0"

Rigging system

permanents pipes spread unevenly all over the theatre ceiling.	46
--	----

Stage masking

full back drops (with an opening)	1	
width	7,31m	24'-0"
height	2,36m	7'-9"

Orchestra equipment

music stand	5	
music stand light	5	
black chair	10	
black wood stool	5	
	3	24" high
	1	28" high
	1	30" high

Pianos (there are additionnal costs for the tuning)

stage	1	Steinway 7'	B - New York
-------	---	-------------	--------------

Step ladder (Louisville / Werner)

	1	2,43 m	8'
--	---	--------	----

Drum carpet

	1	1.83 x 1.83 m	6' x 6'
	1	1.22 x 1.52 m	4' x 5'

Lighting

Stage lighting control

console located back of house S.L.	1	Strand	Light Palette 64
dimmers	78	Strand	CD 80 (2.4 Kw)
circuits on stage and in the house		78	2 Kw
Directs circuits for LED par		18	

Lighting equipment

permanent based lighting			
leko zoom 25°-50°	12	Strand	2205
fresnel 8,8°-59°	3	Altman	6"
fresnel	6	Altman	300L
par zoom 10°-55°	16	DLED	108 RGB
Gobo holder :	23	Strand	
Iris :	6	Strand	



SALLE CLAUDE-LÉVEILLÉE

Sound

Mixing console

Automated console 32 inputs x 16 outputs	1	Digico	SD9 (CORE v2)
located back of house S.L.	1	Digico	UB MADI

House speaker system

speaker top	4	OUTLINE	X123W
speaker sub	6	OUTLINE	EIDOS 108s
amplifier and processor	1	POWERSOFT	X8

Playback & Recorder

CD recorder	1	Tascam	SS-CDR1
CD player with remote control	2	Denon	DN-C635

Stage monitor system

monitors mix including:		5	
passive speaker	2	EAW	SM-200
active speaker	6	OUTLINE	DVS-8SP
In ear complete system	4	Sennheiser	EW 300 IEM G3 B
amplifier	1	QSC	1500

Microphones

1	AKG	426	Stereo + preamp
1	AKG	C451 EB	
1	AKG	C535 EB	
2	Audio Technica	ATM-35	hypercardioïde (with clip)
2	Audio Technica	AT-4053a	hypercardioïde
2	DPA	4099	with 2 piano clips and 2 stand clips
1	Neumann	KSM 105	
2*	Neumann	KM-184	*Unavailable from June until Spetember
1	Sennheiser	MKH40	
3	Sennheiser	MD 421	
1	Shure	Beta 52	
1	Shure	Beta 58	
3	Shure	Beta 87C	
3	Shure	Beta 98	with clip
6	Shure	SM-57	
5	Shure	SM-58	
1	Shure	SM-81	
2	Shure	SM-91	
1	Shure	565 SD	with switch
2	Shure	ULXP4	SM-58 wireless microphone
3	BSS	AR-116	active DI
2	Radial	J48	active DI
3	Whirlwind	IMP-2	passive DI

Video

Recorder	1	DATAVIDEO	HDR70	Hard-drive 320 GB
HD video camera	1	MARSHALL	PTZ CV620	with remote control

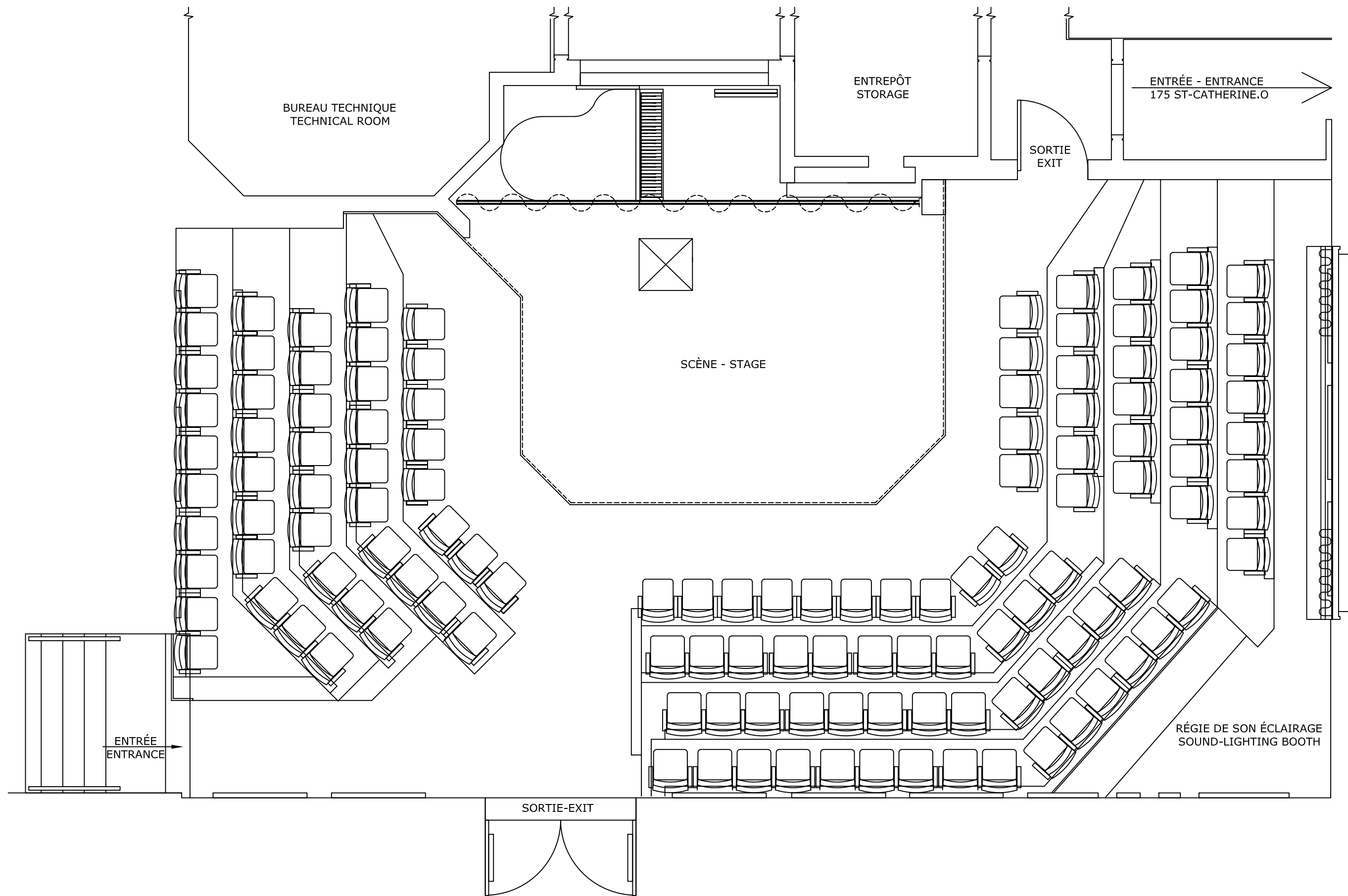

LÉGENDE
 84 en rouge : Zoom channel
 64 1er channel R-G-B

